

COUNTY OF SAN DIEGO WATERFRONT PARK

1600 PACIFIC HIGHWAY ♦ SAN DIEGO, CA 92101

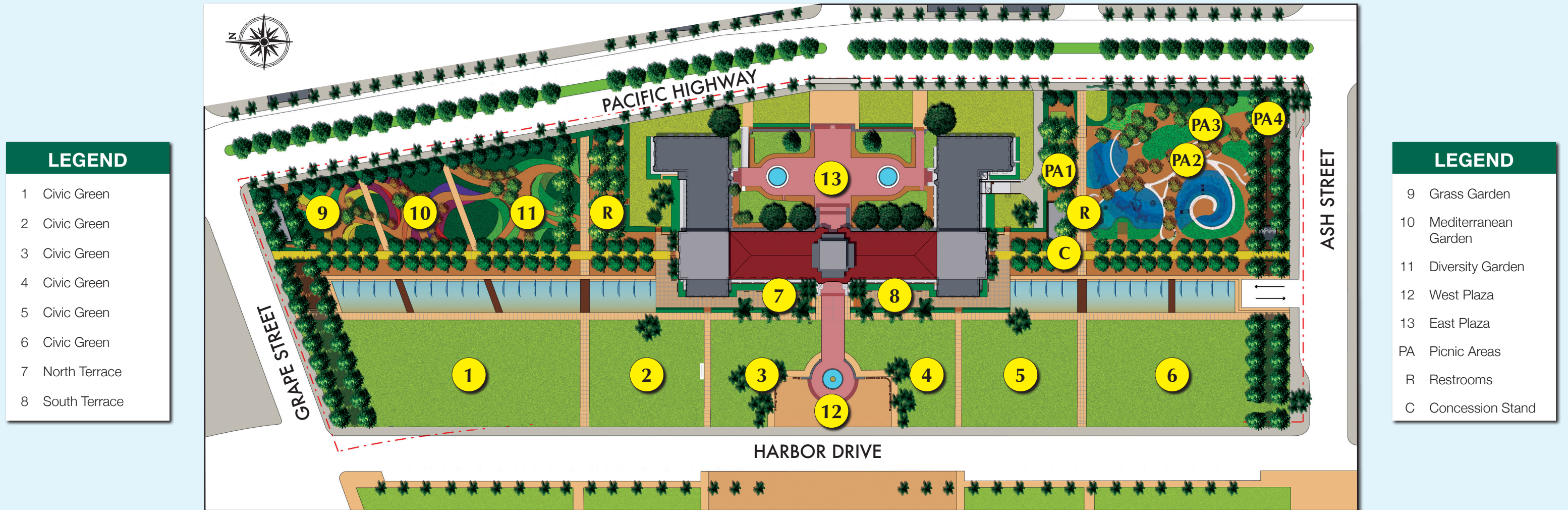

COUNTY OF SAN DIEGO WATERFRONT PARK



LEGEND	
1	Civic Green
2	Civic Green
3	Civic Green
4	Civic Green
5	Civic Green
6	Civic Green
7	North Terrace
8	South Terrace

LEGEND	
9	Grass Garden
10	Mediterranean Garden
11	Diversity Garden
12	West Plaza
13	East Plaza
PA	Picnic Areas
R	Restrooms
C	Concession Stand

RESERVABLE AREAS

Civic Greens

The Civic Greens provide open multi-use activity platforms for events, festivals, and everyday use. The expansive space is an ideal setting for a wedding, family reunion or corporate picnic.

Plazas and Terraces

The broad plazas link the park to the elevated terraces which run the length of the site. These locations can host a variety of events or gatherings with a beautiful view.

Promenades

The Promenade and Civic Fountains serve as the spine of the Park, straddling the Civic Greens and intimate gardens, while offering wonderful views. The Promenades are well-suited for vendor booths, passive activities and observation.

Themed Gardens

Garden Rooms emphasize diverse botanical collections, flowering plants, meandering paths, seating areas and a small central plaza. The gardens can be venues for weddings, holiday celebrations, performances and other passive activities.

Picnic Areas

Picnic areas can be reserved near or in the Children's Play Area. The beautiful backdrop offers a natural setting that all your guests are sure to enjoy for your birthday party or special gathering.

Reservations

619.232.PARK (7275)
sdparks.org



COUNTY OF SAN DIEGO WATERFRONT PARK

1600 PACIFIC HIGHWAY ♦ SAN DIEGO, CA 92101



Since 1938, the County Administration Center has stood on the San Diego Bay welcoming residents and visitors alike, symbolizing the highest aspirations and ideals of public service. The newly constructed Waterfront Park is the most significant waterfront open space in downtown San Diego and fulfills a vision decades in the making, slating it as a quintessential destination for residents and visitors.

The existing historic landscape and landmark County building form the park's center while a new interactive fountain extends from the building and into the park defining a large civic green. The park also features intimate gardens with distinct themes, a children's play zone and several picnic areas. The Waterfront Park's diverse spaces can accommodate public and private special events of various sizes, festivals, farmers markets, and active and passive family recreation.

WATERFRONT PARK FEES

Key	Space	Square Feet	Capacity Standing (@10sf / person)	Capacity Auditorium Style (@15sf /person)	Capacity Seated Banquet Style (@20sf/ person)	Rental Fee Full Day	Rental Fee Half Day	Rental Fee Per Hour
1	Civic Green	38,250	3,825	2,550	1900	\$2,000	\$1,200	\$500
2	Civic Green	20,250	2,025	1,350	1000	\$1,250	\$750	\$300
3	Civic Green*	11,250	1,125	750	550	\$1,000	\$600	\$250
4	Civic Green	11,250	1,125	750	550	\$1,000	\$600	\$250
5	Civic Green	20,250	2,025	1,350	1000	\$1,250	\$750	\$300
6	Civic Green	27,750	2,775	1,850	1350	\$1,500	\$900	\$375
7	North Terrace	3,975	398	265	200	\$500	\$300	\$125
8	South Terrace	3,975	398	265	200	\$500	\$300	\$125
9	Grass Garden	1,125	113	75	50	\$500	\$300	\$125
10	Mediterranean Garden	1,125	113	75	50	\$600	\$350	\$150
11	Diversity Garden	2,438	244	163	125	\$750	\$450	\$200
12	West Plaza	7,125	713	475	350	\$500	\$300	\$125
13	East Plaza	10,125	1,013	675	500	\$500	\$300	\$125
PA	Picnic Areas	—	—	—	50-100	\$150-\$300	n/a	n/a

*Not available Monday – Friday, 8:00 a.m. – 5:30 p.m.

Additional fees may apply



1600 Pacific Highway • Suite 061
San Diego, CA 92101

For Reservations
619-232-PARK (7275) • sdparks.org

